

## AC Adapter

### TYPE ADP-001C Instruction Manual

#### ■ Notice to Customer

Thank you very much for purchasing our PATLITE products.

- Before using this product, thoroughly read the "AC Adapter [ADP-001] Instruction Manual" included with the product, as well as this manual, to ensure proper use.
- If there are any questions concerning this product, refer to the contact information at the end of this document and contact your nearest PATLITE Sales Representative.

#### ■ To the Contractor

- Prior to installation, read this manual thoroughly to ensure correct use.
- Return this manual to the customer.

## 1 Before You Begin

#### ■ About Safety Symbols

- To prevent injuries to the user and other personnel, as well as to prevent damage to assets, note the following.
- The following symbols classify warnings and cautions, and describe the level of harm and damage that will occur when the corresponding instructions are ignored.

**⚠ WARNING** This symbol indicates, "Failure to follow the instructions may lead to death or serious injury."

**⚠ CAUTION** This symbol indicates, "Failure to follow the instructions may lead to injury or property damage."

- The following symbols classify and describe the content of associated messages.

**⊘** This symbol identifies "Prohibited" operations that should never be carried out.

**!** This symbol identifies "Mandatory" instructions that should always be carried out.

#### ■ Safety Precautions

- Before using this product, thoroughly read the "AC Adapter [ADP-001] Instruction Manual" included with the product, as well as this manual, to ensure proper use.

**⚠ WARNING** ⊘ To prevent accidents, do not use this product other than for its intended purpose and do not run operations or maintenance other than those described in this manual. ⊘ Do not modify or disassemble this product. Failure to follow these instructions could result in fire or electric shock. ⊘ Do not use this product when there is condensation. Failure to follow these instructions could result in fire or electric shock. ❶ Turn off the power before wiring. Failure to follow this instruction could result in electric shock.

**⚠ CAUTION** ⊘ Do not use this product near fire, in hot or humid environments, or where corrosive or flammable gas is present. ⊘ Do not use thinners, benzene, gasoline, oil, chemicals, and so on to wipe away dirt on this product. Failure to follow this instruction could result in discoloration and deterioration. Wipe with a soft cloth, dampened with water and wrung tightly. ❶ Pay close attention to the polarity of the power supply before connection. Connecting the power supply incorrectly could result in product failure.

#### ■ Conformity requirements

This equipment has been tested and found to comply with the limits for a Class B digital device, pursuant to part 15 of the FCC Rules. These limits are designed to provide reasonable protection against harmful interference in a residential installation. This equipment generates, uses and can radiate radio frequency energy and, if not installed and used in accordance with the instructions, may cause harmful interference to radio communications. However, there is no guarantee that interference will not occur in a particular installation. If this equipment does cause harmful interference to radio or television reception, which can be determined by turning the equipment off and on, the user is encouraged to try to correct the interference by one or more of the following measures: - Reorient or relocate the receiving antenna. - Increase the separation between the equipment and receiver. - Connect the equipment into an outlet on a circuit different from that to which the receiver is connected. - Consult the dealer or an experienced radio/TV technician for help.

(Responsible party in U.S.A.) PATLITE U.S.A. Corporation, 20130 S. Western Ave. Torrance, CA90501, U.S.A.

Website Address:www.patlite.com

## 2 Package Contents

Package Contents	AC Adapter	Extension cable	Cable tie	Instruction Manual (this manual)
	<p>AC Power Plug UL CCC VDE KC UK ADP-001</p>			<p>Instruction Manual (ADP-001)</p>
Quantity	1 unit	1	1	1 each

## 3 Connection Method

For detailed information on how to use AC plugs, refer to "AC Adapter [ADP-001] Instruction Manual".

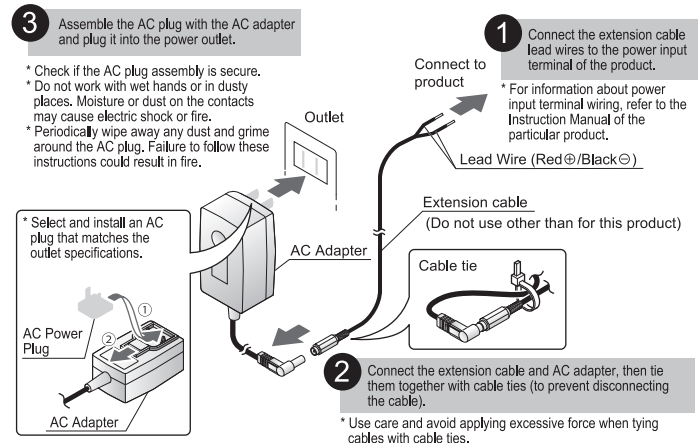

### PATLITE Corporation (G2J)

**PATLITE Corporation** ※Head office ■ www.patlite.com/  
**PATLITE (U.S.A.) Corporation** ■ www.patlite.com/  
**PATLITE Europe GmbH** ※Germany ■ www.patlite.eu/  
**PATLITE (SINGAPORE) PTE LTD** ■ www.patlite-ap.com/  
**PATLITE (CHINA) Corporation** ■ www.patlite.cn/  
**PATLITE KOREA CO., LTD.** ■ www.patlite.co.kr/  
**PATLITE TAIWAN CO., LTD.** ■ www.patlite.tw/  
**PATLITE (THAILAND) CO., LTD.** ■ www.patlite.co.th/  
**PATLITE MEXICO S.A. de C.V.** ■ www.patlite.com.mx/